

# ■ CIWI Line 6

THE APIA CIWI LINE6 IS A PASSIVE SPEAKER SYSTEM, COMPRISED OF 3" NEODYMIUM MAGNET TRANSDUCERS HOUSED IN AN ELEGANT WOOD CASING AND PAINTED WITH WATERPROOF POLYUREA WHICH IS ALSO AVAILABLE IN CUSTOM RAL COLORS.



## SYSTEM DATA

### ■ USABLE BANDWIDTH

Frequency response (-5 dB standard)	125 Hz - 19 kHz
Max. sound pressure (1 m, free field)	128 dB SPL

### ■ LOUDSPEAKER DATA

Nominal impedance	8 Ohm – 32 Ohm (Selectable)
Power handling capacity (RMS/peak 10 ms)	120/480W
Nominal dispersion angle (V)	7° - 10° (selectable)
Nominal dispersion angle (H)	90°

### ■ COMPONENTS

6 x 3" Neodymium magnet with 0.75" voice coil  
Ciwi Sub, Ciwi Infra or QDX-13 amplifier network

### ■ PHYSICAL DATA

Connections	2 x NL4 or
Finish	Fir-green RAL 6009® Polyurea coating
Cabinet	Baltic birch plywood
Rigging	CW-BASE / CW-FLY / CW-FOOT / CW-JOINT / CW-WALL
Protection Rating	IP 45
Dimensions (H x W x D)	507 x 98 x 117 mm
	20 x 3.8 x 4.6"
Weight:	4.5 kg
	13 lb

\* SPL max peak test signal: pink noise with crest factor 4



THE CIWI LINE6'S CLOSELY SPACED CONE DRIVERS PROVIDE PHASE COHERENCE WITH LOW DISTORTION.

TO ACCOMMODATE A RANGE OF APPLICATIONS, THE VERTICAL DISPERSION PATTERN CAN BE SWITCHED FOR EITHER WIDE OR NARROW COVERAGE (7° OR 30°).

OPTIONAL RIGGING AND LINKING ACCESSORIES ALLOW FOR MULTIPLE SPEAKERS TO BE INTERCONNECTED, CREATING A WIDE ARRAY OF VERTICAL AND HORIZONTAL CONFIGURATIONS FOR TEMPORARY OR PERMANENT INSTALLATION.

FOR INTEGRATION WITH OTHER SPEAKERS AND AMPLIFIERS, THE CIWI LINE6 OFFERS SELECTABLE IMPEDANCE (8Ω / 32Ω). SET TO 32Ω, UP TO SIXTEEN CIWI LINE6 SPEAKERS CAN BE POWERED VIA A SINGLE AMPLIFIER CHANNEL, SIMPLIFYING INSTALLATION OF WIDER DISTRIBUTED INSTALLED SYSTEMS.

# ACCESSORIES

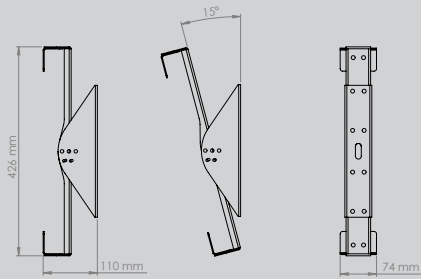

CW WALL H v

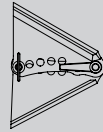

CW JOINT

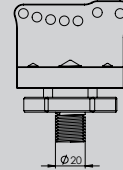
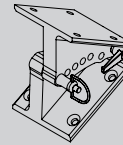
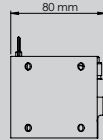
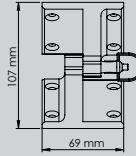

CW FOOT

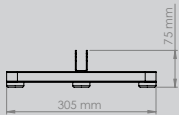
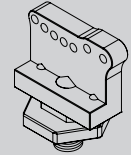
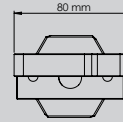
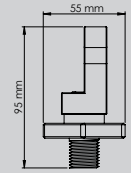

CW BASE

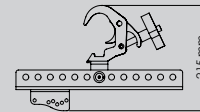
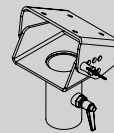
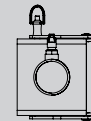
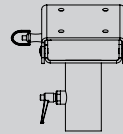
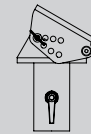
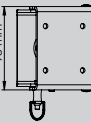
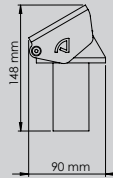
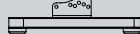

CW FLY

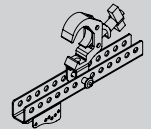
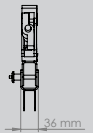

## TECHNICAL VIEWS

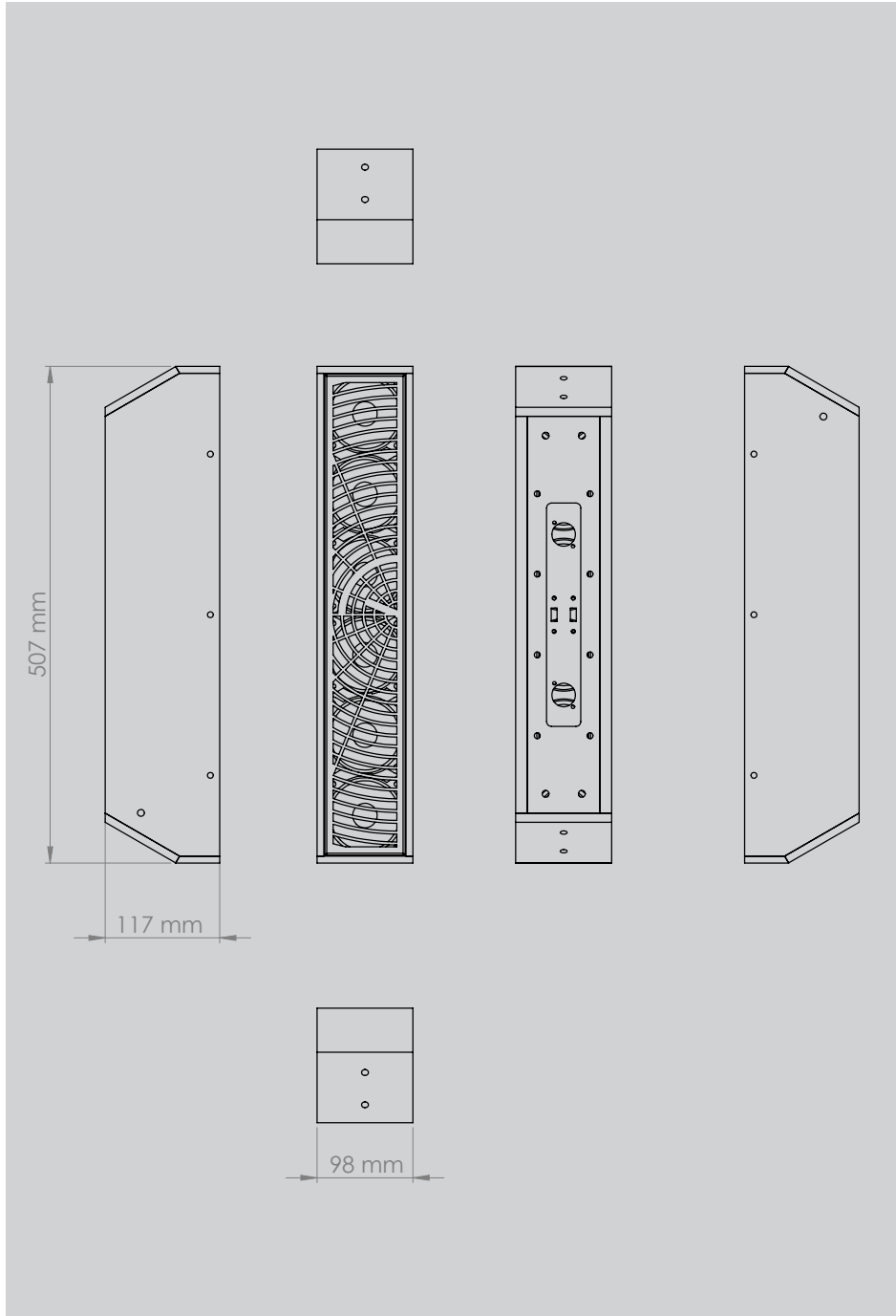

## RIGGING

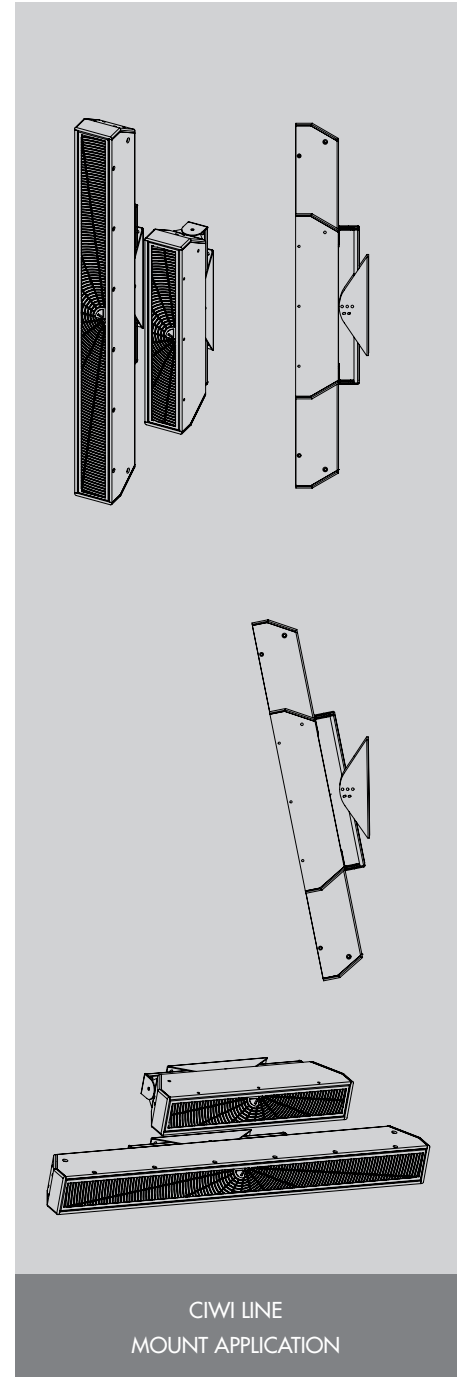

CIWI LINE  
MOUNT APPLICATION

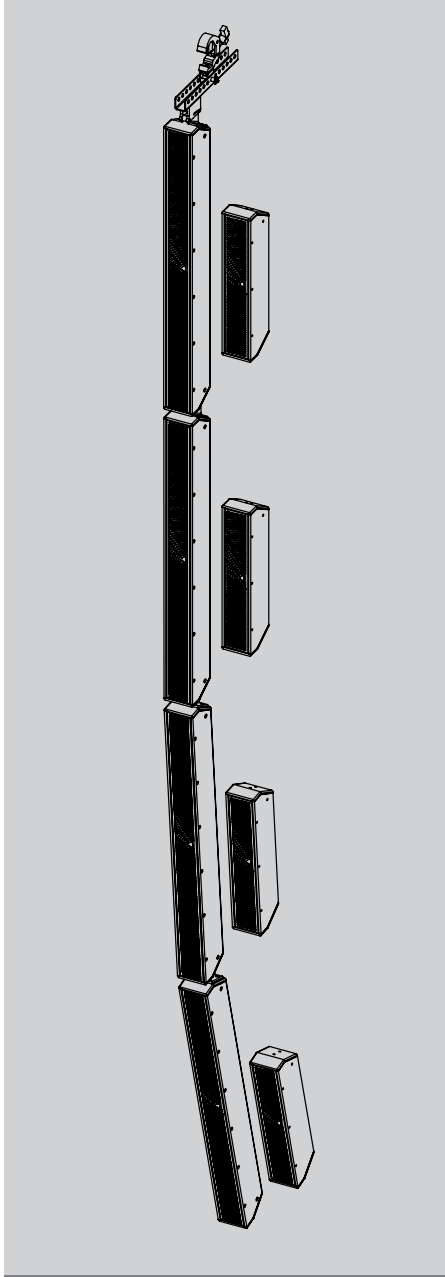

CWI LINE  
RIGGING APPLICATION

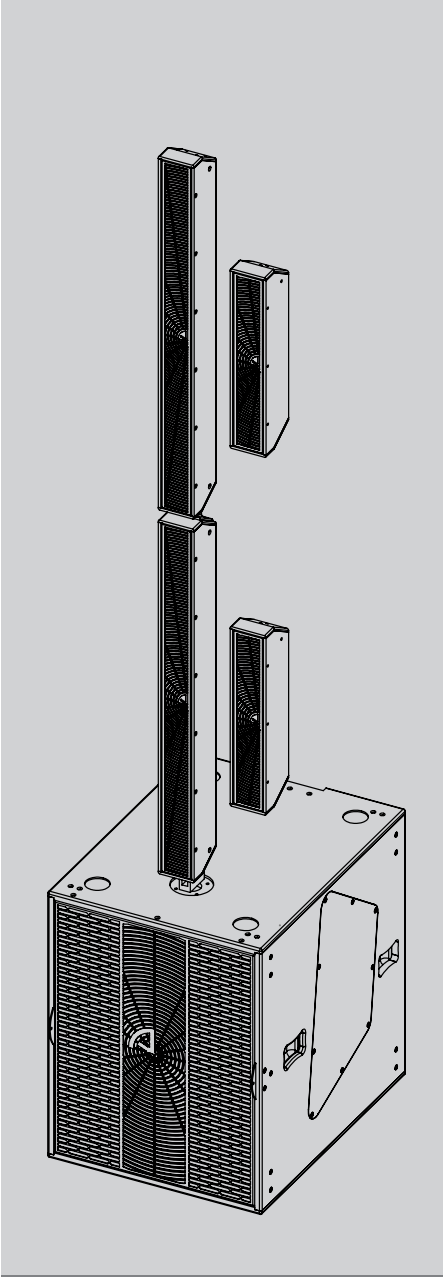

CWI LINE  
GROUND STACK SYSTEM

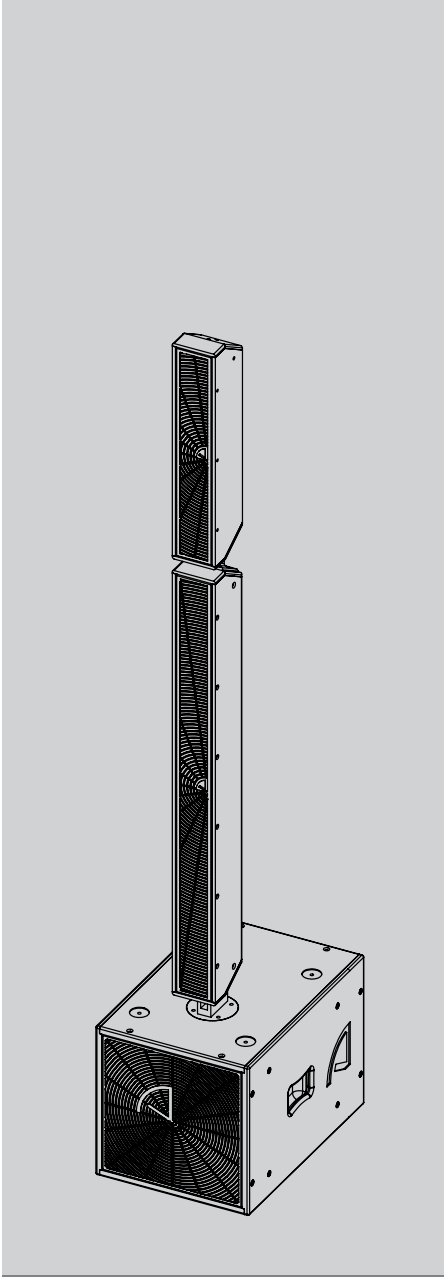

CWI LINE  
GROUND STACK C-SUB SYSTEM